

ASSEMBLY INSTRUCTIONS

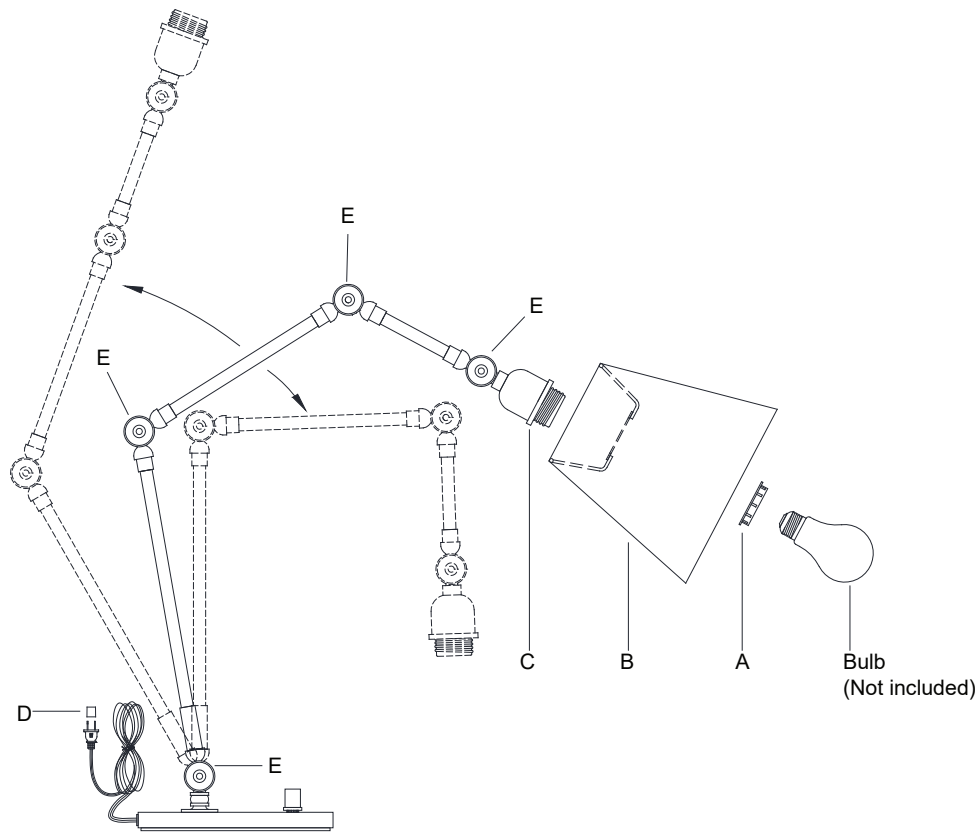

Graves Task Lamp

Item # SK 3115

INSPECT ITEM CAREFULLY BEFORE ATTEMPTING TO INSTALL. IF THERE IS ANY DAMAGE OR OBVIOUS DEFECT. DO NOT INSTALL.

ITEM MAY NOT BE RETURNED ONCE IT HAS BEEN INSTALLED.

NOTE: CAREFULLY UNPACK EACH PIECE IN TOP LAYER OF PACKING PRIOR TO REMOVING. RETAIN ALL PACKING MATERIAL UNTIL INSPECTION AND INSTALLATION ARE FINAL.

1. Carefully remove all parts from the box.
2. Remove the socket ring (A) from the socket (C).
3. Attach the shade (B) to the socket (C) and secure with the socket ring (A).
4. Insert bulb (not included) into the socket.
5. Adjust the fixture by loosening adjustment knobs (E), move to desired angle, and then tighten adjustment knobs (E).
6. Remove the plug cover (D) from the plug.
7. Plug into a proper electrical outlet and test the fixture.
8. Installation is complete.

***Clean with a dry, soft cloth only. Use no harsh abrasives or chemical agents.